

MAXIMUS-3



MAXIMUS-3 JL 2-DOOR ROOF RACK SYSTEM With Rhino Rack Pioneer Platform

INSTALLATION GUIDE

THE MAXIMUS-3 JL 2-DOOR ROOF RACK ONLY FITS (2018-Current) 2-DOOR JL WRANGLERS with HARDTOP or NO TOP.

Please read and understand the entire installation guide before you start this installation. We expect you to have basic mechanical abilities to perform this installation. A second person is recommended for lifting the platform on/off the vehicle.

We recommend that you **separate and identify all the parts and hardware kits you received with your shipment before you proceed to disassemble your Jeep.**

Parts List

| | <u>Qty</u> |
|--|------------|
| Maximus-3 Platform Legs with no Logo | 1 |
| Maximus-3 Platform Legs with Logo | 3 |
| Maximus-3 Front Inner Bracket Assy RHS | 1 |
| Maximus-3 Front Inner Bracket Assy LHS | 1 |
| Maximus-3 Rear Inner Bracket Assy RHS | 1 |
| Maximus-3 Rear Inner Bracket Assy LHS | 1 |
| Rhino Rack Pioneer Platform Kit | 1 |
| Maximus-3 Satellite Antenna Bracket | 1 |
| Option: Maximus-3 Side Ladder | 1-2 |
| Option: Rhino Rack Pioneer Rail Kit | 1 |



Maximus-3 Hardware List

| | <u>Qty</u> |
|------------------------------|------------|
| LEGS to CROSS BARS: | |
| M10 Flanged Hex Bolts – Zinc | 4 |
| M10 Nut Plates – Zinc | 4 |

LEGS to HARDTOP:

| | |
|---|---|
| M8 x 30 Sealing Bolts – Black Stainless | 8 |
| M8 Nyloc Nuts – Stainless Steel | 8 |
| Rubber Gaskets/Washers | 8 |

INTERNAL BRACKETS TO SPORTS BAR:

Front Brackets

| | |
|----------------------------------|---|
| M8 x 25 Flanged Hex Bolts – Zinc | 6 |
| M8 x 20 Flanged Hex Bolts – Zinc | 4 |

Rear Brackets

| | |
|----------------------------------|---|
| M8 x 25 Flanged Hex Bolts – Zinc | 8 |
| M8 Nyloc Flanged Nuts – Zinc | 4 |

Option: Ladder Hardware Kit (per ladder) Qty

Top Kit:

| | |
|---------------------------------------|---|
| M8 Truss Head Bolts – Black Stainless | 2 |
| M8 Channel Nuts - Zinc | 2 |
| 8 mm Washers – Stainless Steel | 2 |

Bottom Kit:

| | |
|---|---|
| M8 Truss Head Bolts – Black Stainless | 2 |
| M8 Flanged Nyloc Nuts – Stainless Steel | 2 |

Interior Kit:

| | |
|---------------------------------------|---|
| M8 Truss Head Bolts – Stainless Steel | 2 |
| M8 Serrated Flange Nuts – Zinc | 2 |
| 8 mm Flat Washers – Zinc | 2 |

Tools Required

Metric Drive Sockets and Extensions
Metric wrenches/spanners
Metric Measuring Tape
Driller and Drill Bits
Metric Allen Key # 5
Masking or Painter's Tape

INSTALLATION STEPS

A- ASSEMBLE THE PIONEER PLATFORM

1. Assemble the Pioneer Platform using Hardware and Instructions provided with Rhino Rack platform kit. (Step 1-12)
2. Lay the assembled Pioneer Platform upside down on a protective surface to avoid surface damage.
3. Attach platform crossbars according to IMPORTANT mounting locations as shown below.

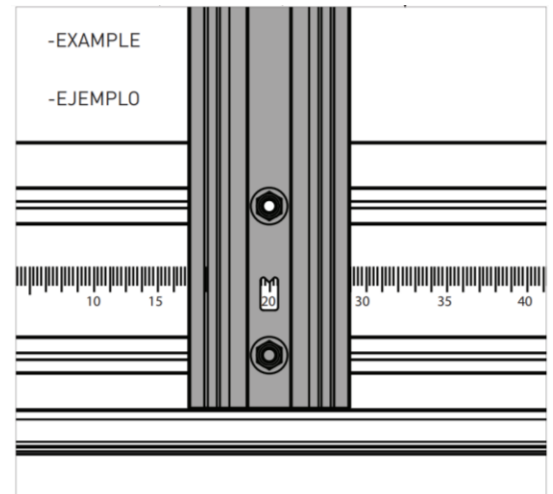
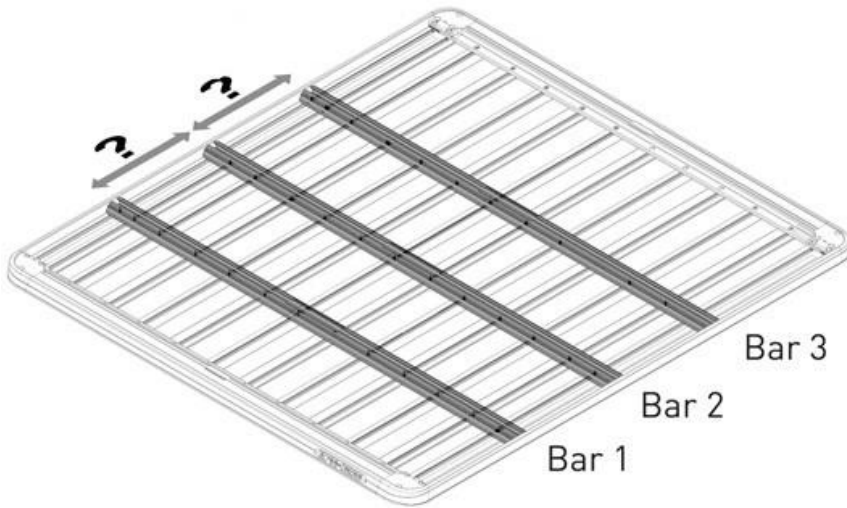

FOR 52" PLATFORM

- Crossbar #1 attaches in mounting location 48.5 CM (485 MM) mark on the numbered ruler scale on both sides
- Crossbar #3 attaches in mounting location 27.5 CM (275 MM) mark on the numbered ruler scale on both sides
- Crossbar #2 attaches evenly between crossbar #1 and crossbar #3 – or attach spaced as desired

FOR 60" PLATFORM

- Crossbar #1 attaches in mounting location 58 CM (580 MM) mark on the numbered ruler scale on both sides
- Crossbar #3 attaches in mounting location 18 CM (180 MM) mark on the numbered ruler scale on both sides
- Crossbar #2 attaches evenly between crossbar #1 and crossbar #3 – or attach spaced as desired
- Crossbar #4 attaches evenly in the space in front of crossbar #3 – or attach spaced as desired

B- INSTALL MAXIMUS-3 ROOF RACK LEGS TO PLATFORM CROSSBARS

1. Loosely attach Maximus-3 Roof Rack Legs to crossbar #1 and crossbar #3 using the M10 Hex Bolts and Channel Nuts provided - leave loose enough to adjust in the next steps.
 - Two Legs on Crossbar #1 (REAR of platform)
 - Two Legs on Crossbar #3 (FRONT of platform)

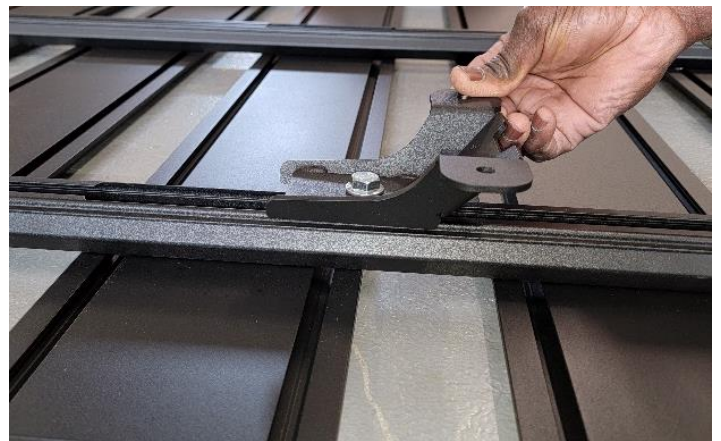

2. Measure and Adjust the Legs according to IMPORTANT final dimensions below.
 - **Distance between Front Leg and Rear Leg = 760 mm** measured from center to center of leg bolt holes, shown below
 - **Distance between Left Leg and Right Leg = 1155 mm** measured from center to center of leg bolt holes, shown below

IMPORTANT:

- ✓ Left Legs to Right Legs must be symmetrically centered on the platform to the nearest 1/16 Inch (1.6mm).
Dimension A Left = Dimension A Right.
- ✓ All four legs must be squarely placed on the platform – take diagonal “X” measurements to confirm squareness to nearest 1/8 Inch (3mm).
- ✓ **Double check your measurements and tighten down all 4 legs. Torque to 22 ft.lb**

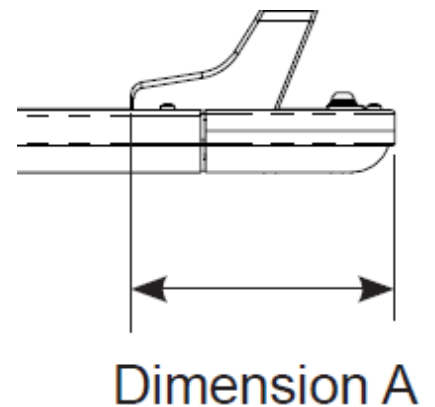
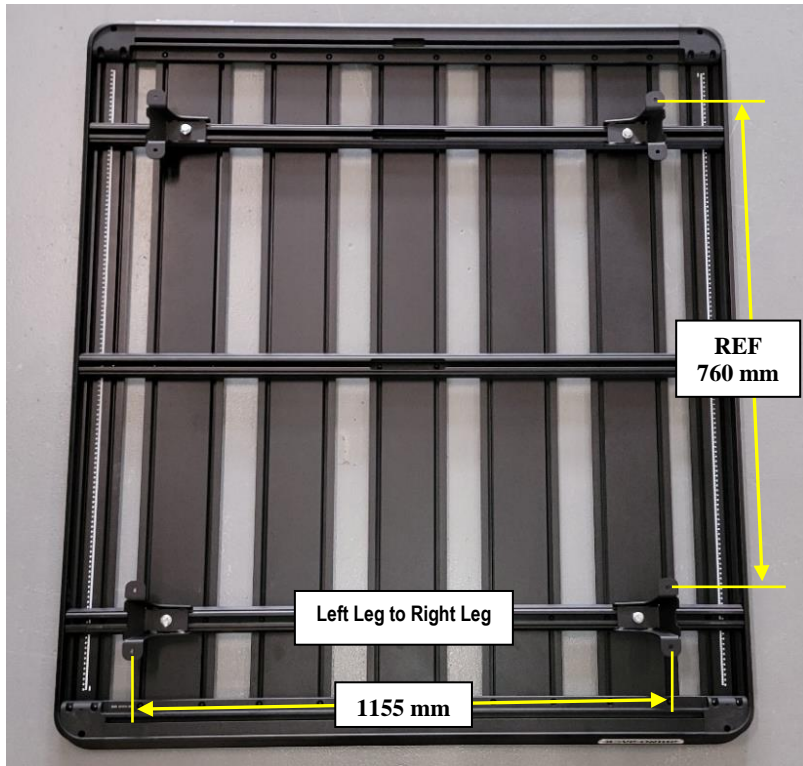

PREP THE JEEP

C- REMOVE THE SOUNDBAR AND TRIM PANELS

1. Remove all T-25 torx bolts from the Sports Bar plastic trim Pieces. Then carefully pull to release clips and remove trim panels.
2. Unclip all electrical harnesses from Soundbar and Antennas (4x harnesses in JL Rubicon)
3. Remove all six (6) Soundbar bolts, using a 10 mm socket/wrench.



D- DRILL HOLES IN HARDTOP FOR MOUNTING PLATFORM ASSEMBLY

1. Remove the Freedom Tops and place on a protective surface.
2. Apply masking tape to the four corners of the hardtop as shown below. This will help when marking drill points and also to protect the hardtop during fitments.
3. **REAR MEASUREMENTS:** mark the rear-most drill location at **50 mm** from the hardtop joint line and **62mm** from outer raised edge as shown below. REPEAT on the other side.
4. **FRONT MEASUREMENTS:** measure and mark a line 70 mm from the outer raised edge of the hardtop – your line should be roughly parallel to the vehicle (passing through the rear mark)
5. With help from a second person, lift the Platform over the Jeep and carefully place on the Hardtop
6. Carefully align the rear-most hole of Rear Platform Legs with the back drill point you marked in step (D3) above. Make sure all 4 legs sit well on the hardtop with front legs holes closely lining up on the lines you marked in step (D4).
- ✓ **Double check before you mark your final drill points – adjust the legs if needed.**
7. Using a pen/pencil, mark all drill points on the Hardtop through leg holes as shown below – 2 for each leg.
8. Carefully lift and remove the Platform from the hardtop.
9. With the Platform removed mark precise center points of the drill marks – total 8 drill points.
10. Drill pilot holes with a small drill bit and then drill 9 MM (3/8") final mounting holes – drill through headliners if you have.
11. Remove masking tape from the mounting surface and clean the surface for final install.

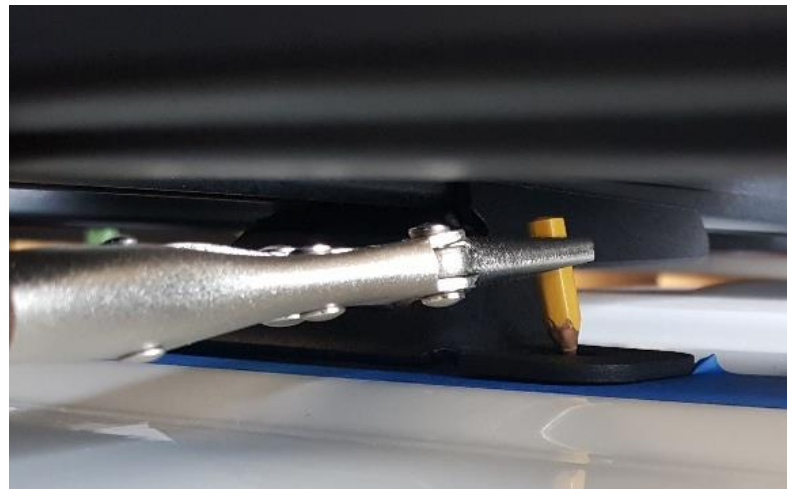
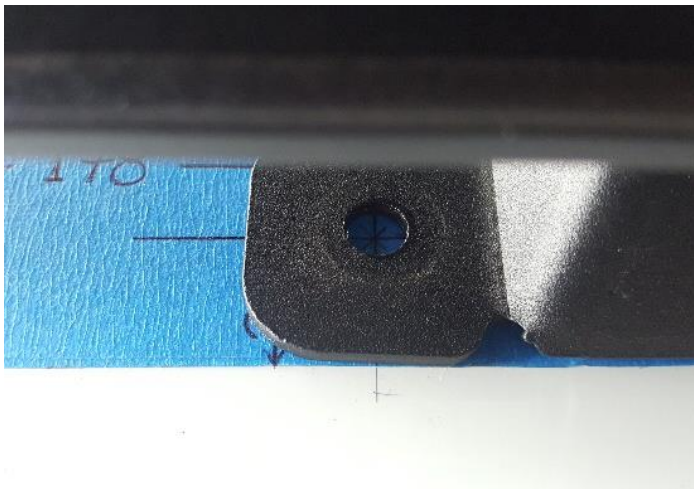

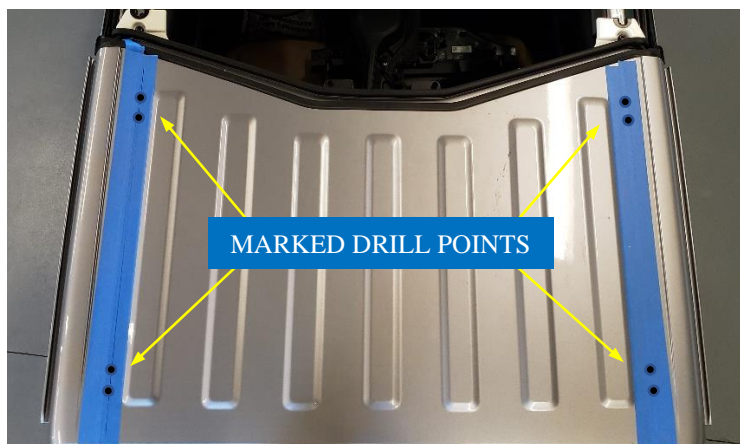

IF YOU ARE NOT INSTALLING SIDE LADDER(S) PLEASE PROCEED TO NEXT STEP (F).

E- DRILL HOLES FOR MAXIMUS-3 SIDE LADDER BRACKET

1. Mark a drill point for rear mounting hole **90 mm** from the middle Hardtop bolt and **38 mm** from the Hardtop wall (in line with factory hardtop bolts).
 2. Mark the front hole **274 mm** from the back hole you just marked. Use the Ladder Bracket to check/verify your marking.
 3. Drill pilot holes through the Hardtop and body sheet metal using a small drill bit then drill final holes with a **9 mm (3/8")** drill bit. Please refer to pictures below.
- WARNING: Avoid drilling into wires that run along the body tub under the plastic panels – do not drill deep.**
4. Clean drilling debris and dust with a vacuum cleaner. Touch up the inside of drilled holes with paint for rust proofing.

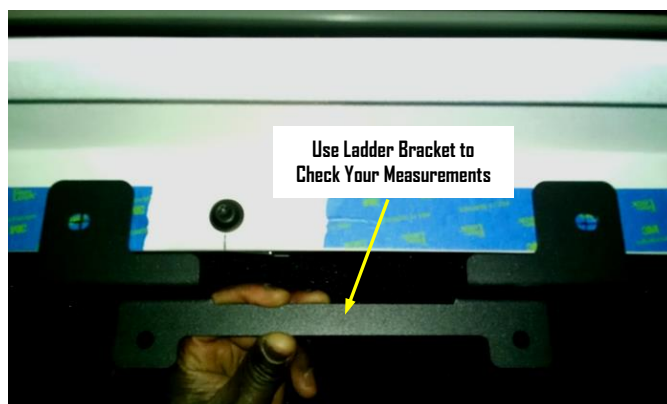
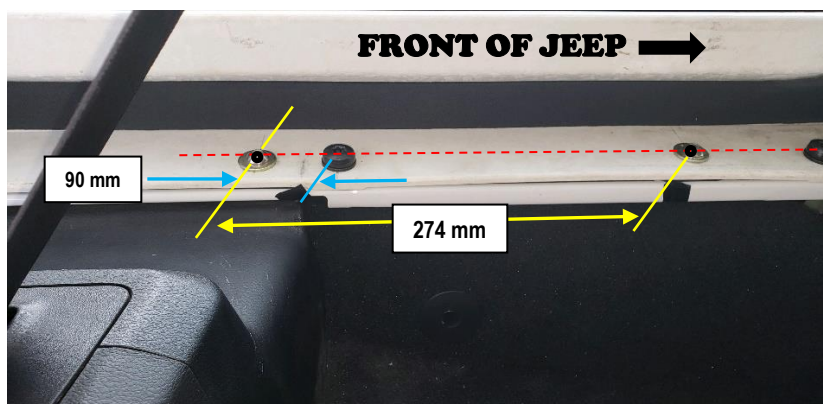

F- MOUNT THE PLATFORM ASSEMBLY ONTO THE HARDTOP

1. Insert legs Sealing Bolts (pre-assembled bolt + sealing washer) through the legs and add Rubber Washers as shown below. Do it for all four (4) legs.
2. With help from a second person, lift the Platform assembly and carefully place on the Hardtop. Carefully align all 8 mounting bolts with the holes you drilled in the hardtop in step D10.

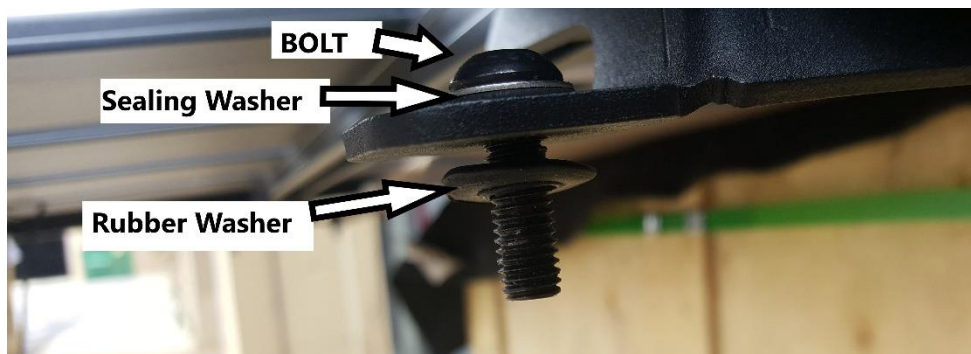

G- INSTALL MAXIMUS-3 FRONT INTERIOR BRACKET ASSEMBLIES

1. Identify the Left side and the Right side of internal brackets. Refer to picture below. Separate the parts A, B and C from each other - note how parts are assembled, also note location of bolts.
2. Unbolt the Hardtop – there are 2 bolts up at freedom tops joints in the front and 6 bolts inside in the back.
3. Lift front of the hardtop and prop up a few inches, use anything such as: block of wood, plastic, or a roll of tape.
4. Slide bracket A in place over sport bar brace plate, align to threaded mounting hole on brace plate and bolt down using M8 flanged bolt provided, as shown below. Repeat on the other side and tighten the bolts.
5. Place bracket B over bracket A, align mounting points on the side and bolt down using 2 zinc M8 flanged bolts provided as shown below - make sure the brackets seated flat against each other. Repeat on the other side and tighten the bolts.
6. Place bracket C to bracket B as shown below - make sure the bends point inwards of the Jeep and the lower top surface points to the front of the Jeep such that the bracket seats flat on fiber glass surfaces.
7. Insert 2 M8 flanged bolts, thread the bolts on, but leave loose for now to allow adjustment.

IF YOU ARE INSTALLING SIDE LADDER(S) SKIP TO NEXT STEP (H), OTHERWISE CONTINUE (7).

8. Remove the block/prop and seat the hardtop back making sure that all 4 front leg bolts are lining up with holes in top front brackets C.
9. Re-install the Hardtop bolts – total 8 factory bolts.
10. Now tighten front top leg bolts using Nyloc nuts and washers provided – you will need a second person to hold the leg bolts from top with an Allen Key while you tighten the nuts from inside. Tighten all 4 bolts to **10 ft.lb**
11. Using 13 mm socket, extension and ratchet tighten all 4 yellow hex bolts holding brackets B and C. Inspect all front brackets fitment and make sure all bolts are tightened.

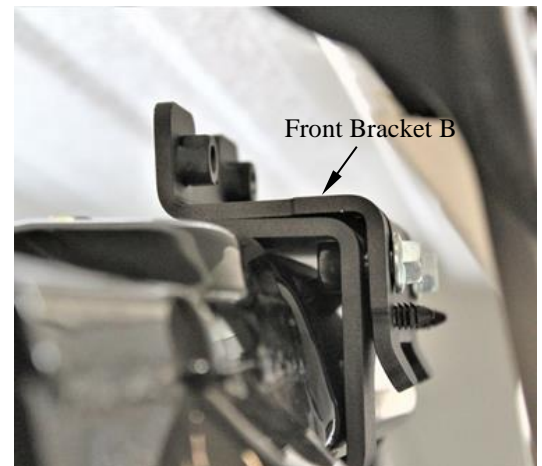
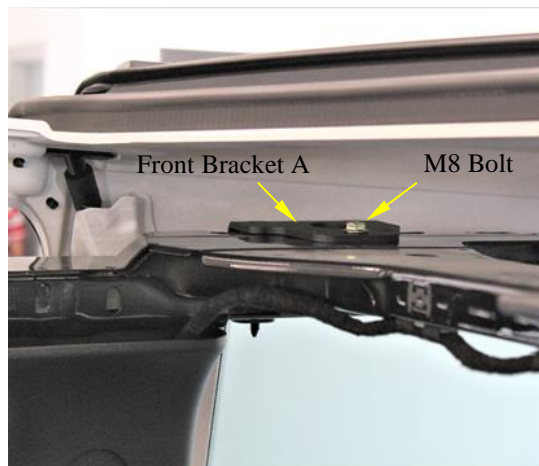
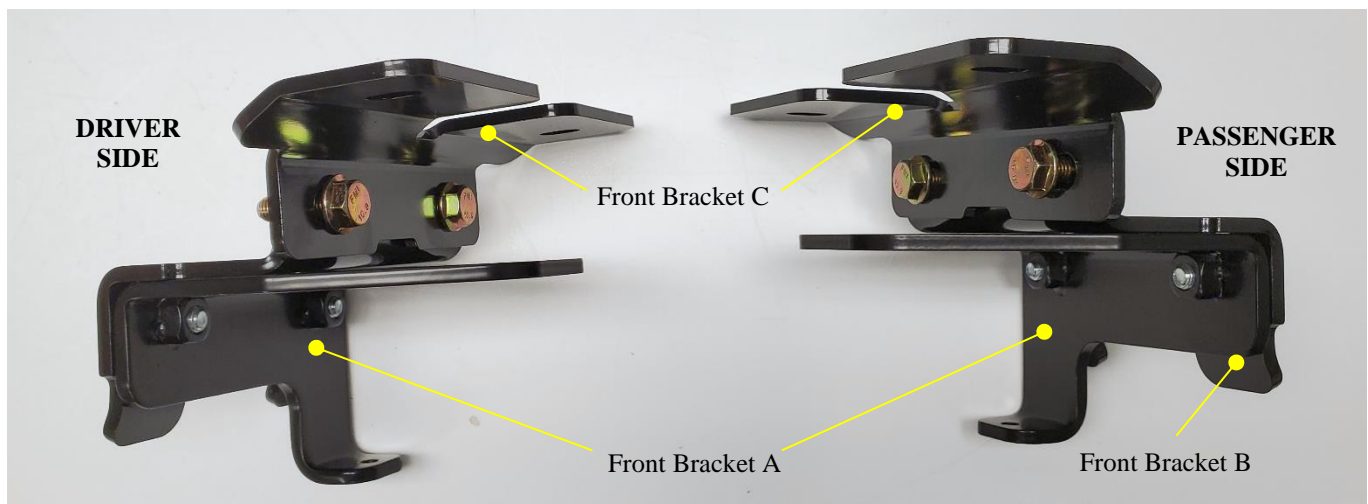

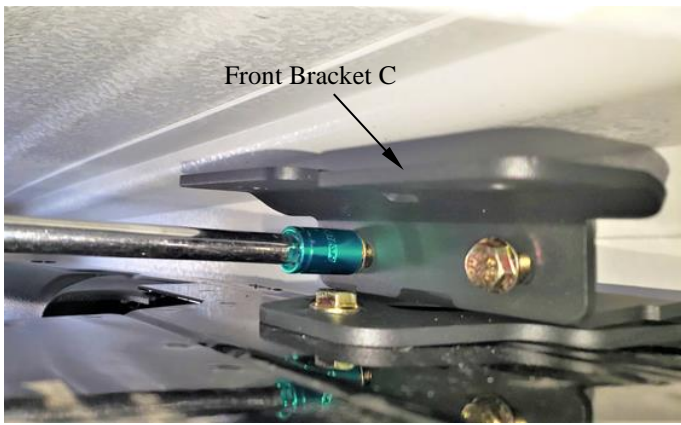

IF YOU ARE NOT INSTALLING SIDE LADDER(S) SKIP TO NEXT STEP (I)

H- INSTALL MAXIMUS-3 SIDE LADDER BRACKET (OPTION)

1. With the hardtop still propped up as directed in step G3, insert the Ladder's bottom support bracket between hardtop and the body tub. Align the bracket holes to your pre-drilled holes in step E3. You may use tape to temporarily hold the bracket in place on the body.
2. Remove the block/prop and seat the hardtop back. Make sure the ladder bracket is in place and holes line up. *Also make sure that all 4 front leg bolts are lining up with holes in top front brackets C.*
3. Bolt the ladder bracket down using M8 bolts, flat washers flanged nuts supplied. Tighten the bolts.
4. Re-install the Hardtop bolts – total 8 factory bolts.

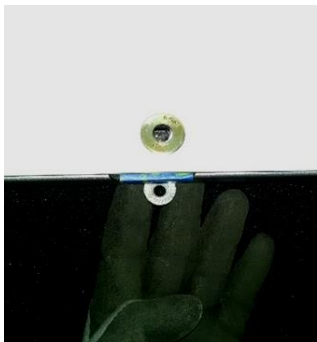

FINISH INSTALLING FRONT BRACKETS

5. Now tighten top leg bolts using Nyloc nuts and washers provided – you will need a second person to hold the leg bolts from top with an Allen Key while you tighten the nuts from inside. Tighten all 4 bolts to **9 ft.lb**
6. Using 13 mm socket, extension and ratchet tighten all 4 hex bolts holding brackets B and C. *Inspect all front brackets fitment and make sure all bolts are tightened.*

I- INSTALL MAXIMUS-3 REAR INTERIOR BRACKET ASSEMBLIES

1. Identify the Left side and the Right side of internal brackets. Refer to picture below. Slightly loosen the 2 bolts holding bracket A and B together, but do not separate.
2. Slide the top part of the rear bracket B through the two leg bolts and hold up against the fiber glass. Note that bent part of the bracket points inwards of the Jeep. Refer to picture below.
3. Align the bottom of bracket A to factory threaded mounting holes in the side of the sports bar and bolt down using 2 yellow M8 flanged bolts supplied – adjust the bracket and tighten the two bolts using 13 mm socket.
4. Now tighten top leg bolts using Nyloc nuts and washers provided – you will need a second person to hold the leg bolts from top with an Allen Key while you tighten the nuts from inside. Tighten all 4 bolts to **10 ft.lb**
5. Using 13 mm socket/wrench tighten all 4 yellow hex bolts holding brackets A and B together. *Inspect all front brackets fitment and make sure all bolts are tightened.*



J- RELOCATE SATELLITE ANTENNA

Satellite Antenna is located above the crossbar, where you removed the sound bar.

1. Un-bolt Satellite Antenna and separate it's wire from other wires by removing the tape holding them together.
2. Free long enough wire to relocate the satellite antenna to front windshield frame (above driver side sun visor)
3. Pre-assemble your antenna to the bracket using the short M6 stainless bolt provided (you can also use the factory bolt)
4. Using the thick washer as a spacer between bracket and windshield frame, install the Antenna Relocation Bracket to the hole on the windshield frame with the longer M6 bolt, washer, and flange nut.
5. Connect the antenna and tug the wire behind the trim panels.

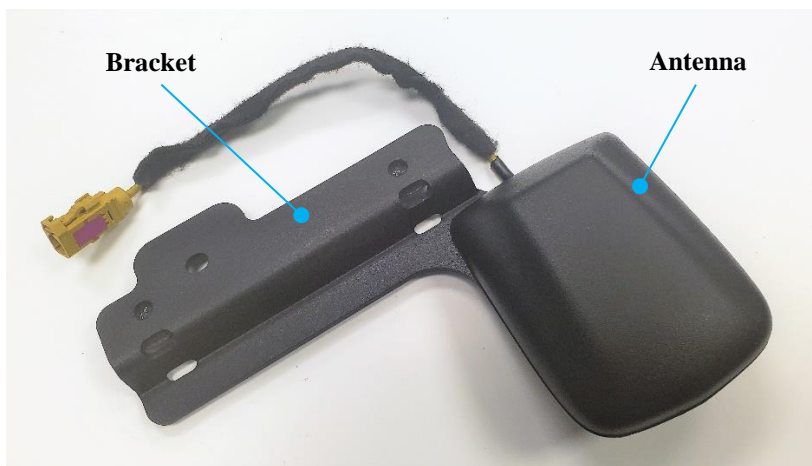

K- REINSTALL SOUNDBAR AND FACTORY PLASTIC TRIM PIECES

1. Attach electric connectors and re-bolt the soundbar into place.
2. Trim the corner of B-pillar trim pieces using a pair of scissors/snips. This cut is needed to clear front internal bracket A. See pictures.
3. The trim pieces will clip back into place.

L- INSTALL THE SIDE LADDER (OPTIONAL)

1. Insert two M8 Channel Nuts in the Rack Platform side bar through the access slot in the back. see pictures bellow.
2. Place the Ladder over the side bar, align Channel Nuts and loosely secure with M8 Stainless Steel Bolts and Washers.
3. Align the bottom of the ladder to the holes on the Ladder Bracket you installed in step (H) and loosely secure with M8 Stainless Steel Bolts, Washers and nylock nuts provided. Do not tighten for now.
4. Check that top of the Ladder seats flat on the Platform side bar and tighten the bolts.
5. Align the bottom brackets and tighten using an Allen Key and a 13 MM wrench – you may need to push or pull on the ladder leg to align.

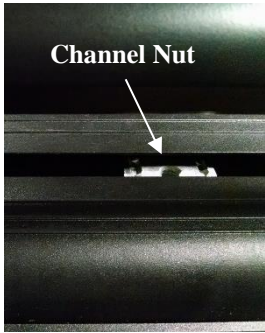

Your installation is complete. If you have questions regarding this installation, please contact us at info@maximus-3.com or call 248 821 6654.

MAXIMUS-3



WARNING



Limited Warranty

We offer **Limited Warranty** on products engineered and manufactured by **MAXIMUS-3**.

Our **Warranty** covers all workmanship, material and paint/finish defects for a period of 1 year (12 months) from the time of initial purchase.

All Maximus-3 aftermarket products and components must be installed as the manufacturer instructs. Maximus-3, LLC will not be responsible for any modification, improper installation, alteration, tampering, neglect, abuse or misuse of our products. Only use Maximus-3 installation guide to add, alter, or fabricate factory parts to incorporate Maximus-3 products. We will be happy to answer any questions concerning the design, function, and correct use of our products by calling 248-821-6654. It is ultimately the user's responsibility to have all fasteners properly retorqued after the first 100 miles and then every 3,000 miles thereafter. Tire carrier must be inspected for looseness every 1,000 miles. Using your vehicle off-road will put extreme stress on the vehicle and components. After driving off-road, always check for damage and wear to components, accessories, and equipment. Completely inspect your vehicle including wheels, tires, tire carrier, roof rack, and front set up. Check all threaded fasteners for looseness. Re-torque if necessary to the required specifications. Check and remove any accumulated dirt, mud rock, or debris to preserve powder coat finish/rust prevention.

MAXIMUS-3 provides detailed installation instructions for every product. It is the responsibility of the purchaser / installer to ensure these instructions are followed properly. MAXIMUS-3 will not be responsible for damages caused by misuse, altered or improperly installed products. MAXIMUS-3 will not cover paint or labor costs for damaged items. Warranty is not transferable and covers all items ordered on or after December 1, 2012 with a valid original receipt.

Warranty covers all components manufactured by MAXIMUS-3 unless otherwise specified on individual product listings.

3 Year Manufacturer Warranty

Maximus-3 products are warranted to be free from structural defects. All metallic components will carry 3-year manufacturer structural warranty. All warranty claims shall be issued in replacement of the original part or in-store credit. No refunds will be issued in cash, check or credit card payments.

ANY PACKAGES BEING SENT/RETURNED TO MAXIMUS-3 WITHOUT RETURN MERCHANDISE AUTHORIZATION (RMA) NUMBERS WILL BE REFUSED AND RETURNED TO SENDER.

RETURN POLICY

(Procedures for Returning or Exchanging Product)

PRODUCT MUST BE RETURNED TO THE ORIGINAL PLACE OF PURCHASE – Please refer to your original invoice.

Returns and Exchanges

At MAXIMUS-3 we strive to get your order to you complete, undamaged and 100% correct. Your satisfaction is guaranteed. Products can be returned within 15 days of shipment as long as they are unused, uninstalled, unpainted and in new and saleable condition. Returned products need to be in their original packaging with all parts and instructions included. All returns of non-defective, non-damaged or special-order parts are subject to a 15% restocking fee, unless we made an error.

All returns require a "Return Merchandise Authorization" (RMA) number from MAXIMUS-3 or one of our Distributors.

Whether we have made an error, you wish to exchange something, or there is a warranty claim, an RMA number is required. This number must be written on the outside of the returned package. Please allow five (5) business days for refunds to appear on your credit card statement. **No returns will be accepted on modified, "Custom" or "Special Order" items.** Item(s) must be received within 30 days of the RMA issue date; otherwise the Return Merchandise Authorization will be voided.

Damaged Merchandise

Upon receiving your order, open the carton(s) and thoroughly inspect the contents. If any package arrives and shows signs of external damage, you may choose not to accept it. You may refuse it and require your seller to advise you of their procedure to follow. If there was damage during shipment, contact us so that a claim can be filed. Please keep all packaging materials should the carrier wish to inspect them.

Truck Freight Shipments

It is imperative to make a note of any damage on the delivery receipt at the time of delivery. **Open and inspect** the merchandise carefully **before** signing the delivery receipt. We can only initiate claims if the damage was noted at the time of delivery. Freight costs are all based on shipments to commercial addresses (with a dock), if you require shipment to a residential address, additional charges may be applied to the order total.

Products

Product specifications, availability and pricing are all subject to change without notice. National, State, Provincial or local laws and regulations may prohibit the removal or modification of stock vehicle components, or the addition of some of our products for on road use. It is the responsibility of the purchaser to ensure that the use of purchase products follows all laws and regulations.